

3.65M (A)

85MM (B)

A Ø 20mm

B Ø 25mm

A B PORT TPC1942 / SBT-B-01

B S PORT TPC1943 / SBT-S-01

Diagram showing the top cover being placed on the frame and the connection of the cables to the ports.

Diagram showing the side panels being attached to the frame and the connection of the cables to the ports.

Diagram showing the bottom cover being attached to the frame and the connection of the cables to the ports.

Diagram showing the connection of the cables to the ports.

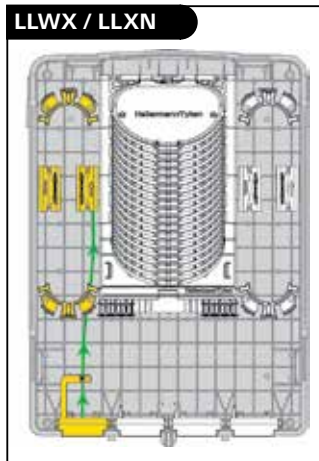
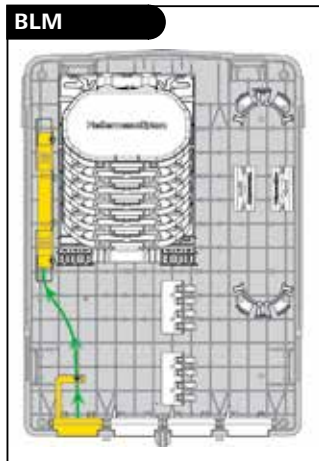
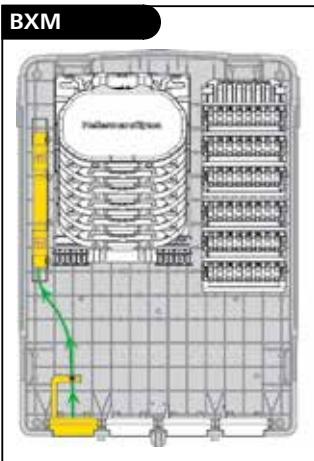

**BXM / BLM**

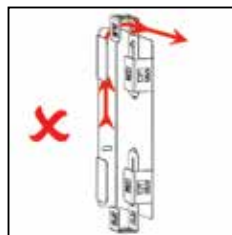
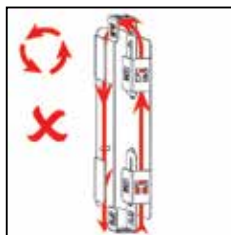
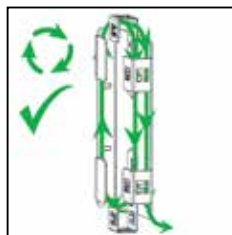
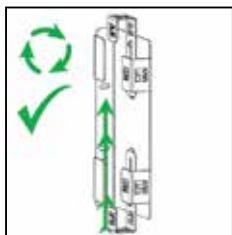

**BLM / LLWX / LLXN**

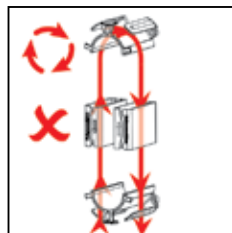
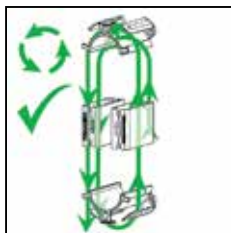
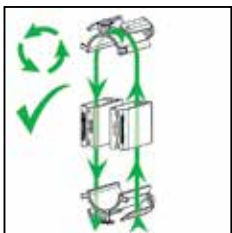
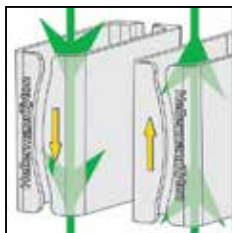
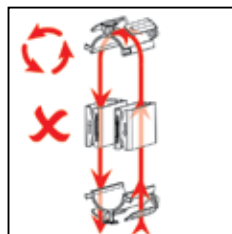
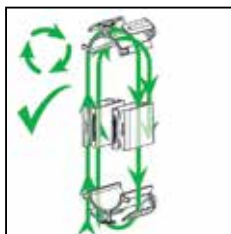
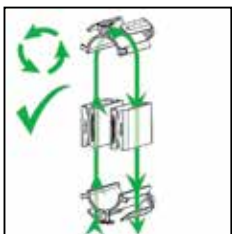
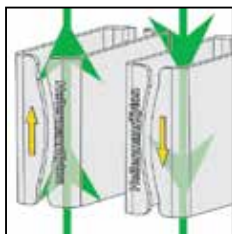

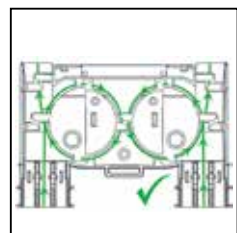
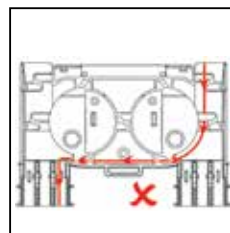
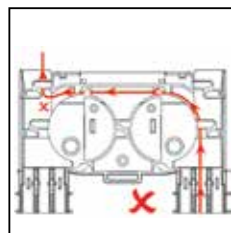
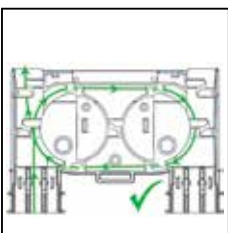
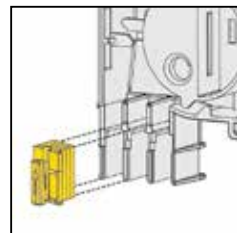
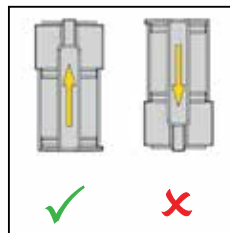
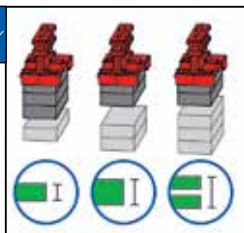
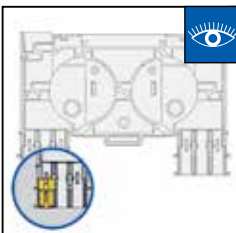
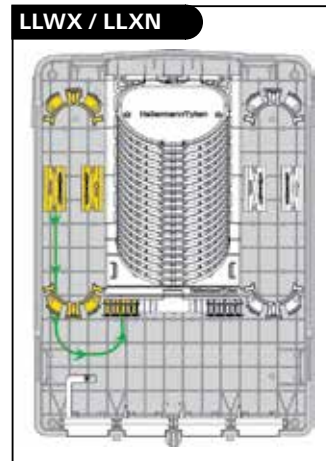
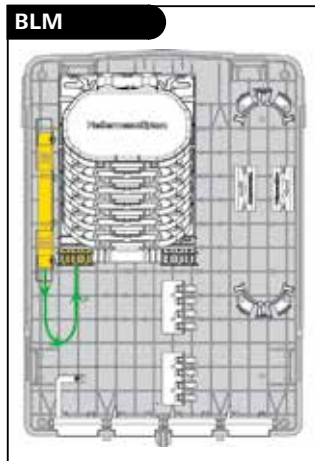
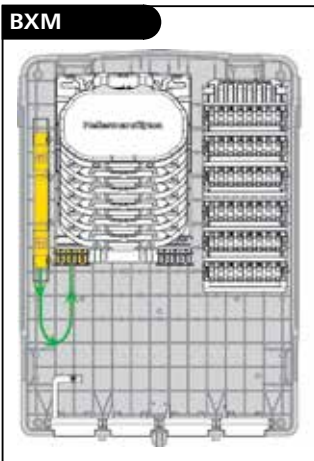



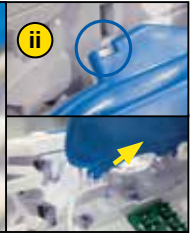
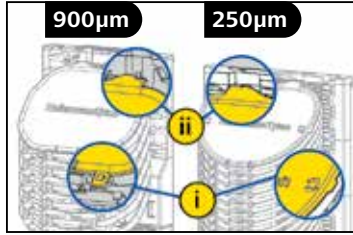
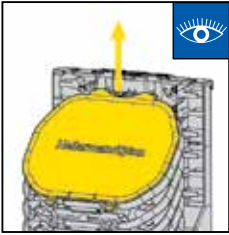

900µm

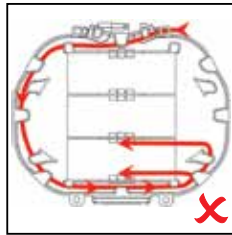
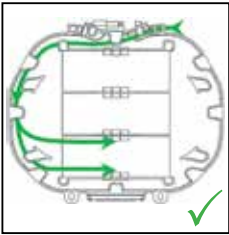
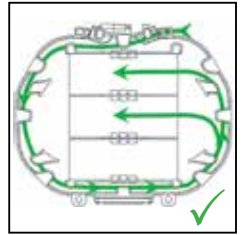
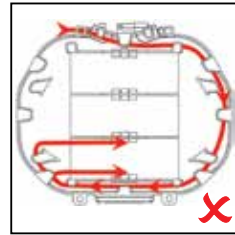
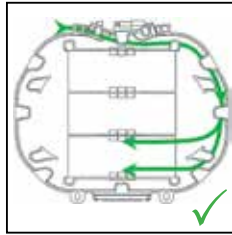
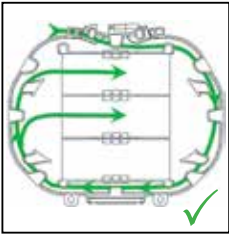
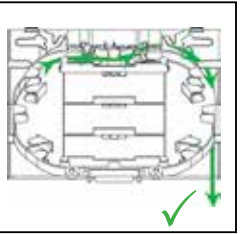
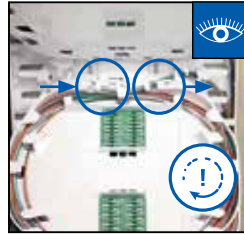
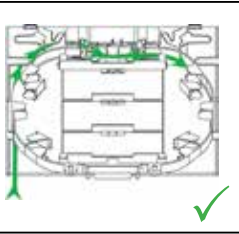
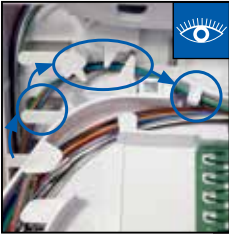

250µm

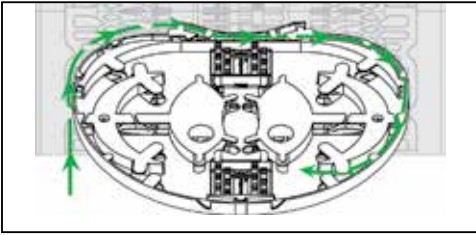

SE-IR

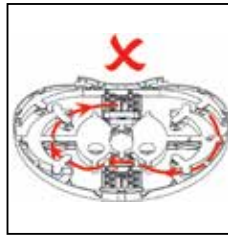
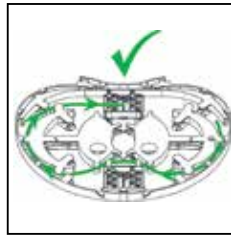
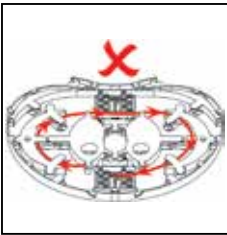
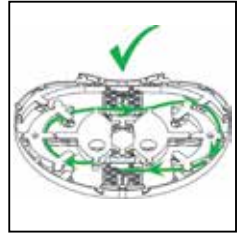
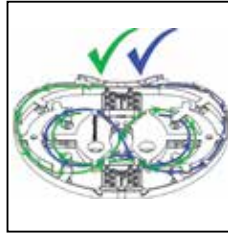
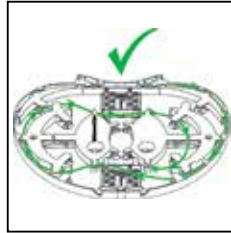
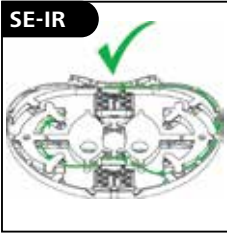

SC-B-IR

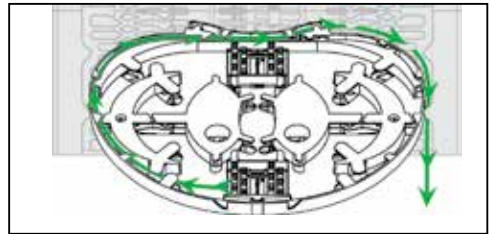
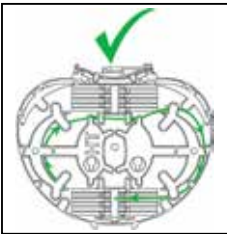
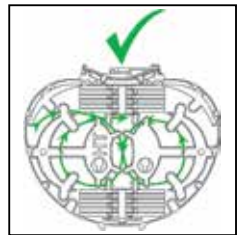
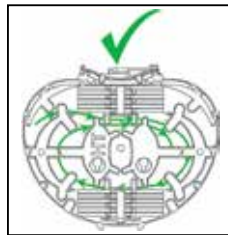
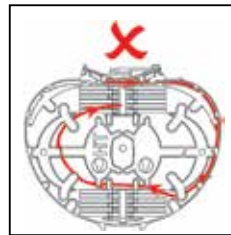
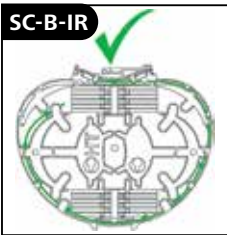

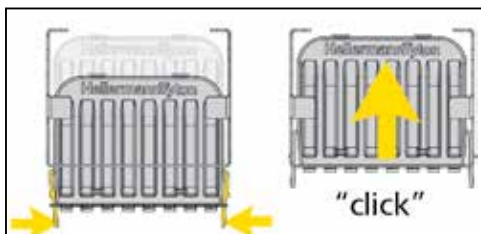
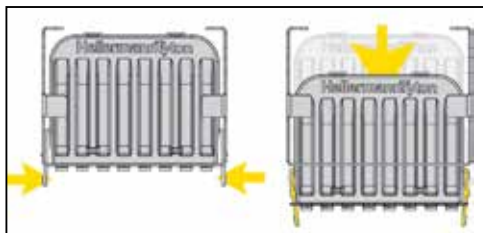
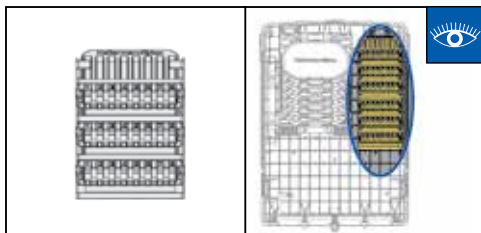
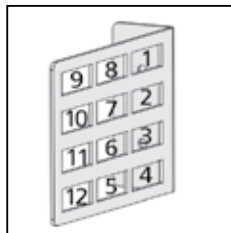
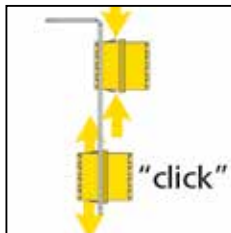
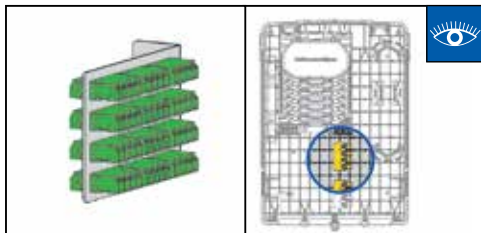



**BXM**

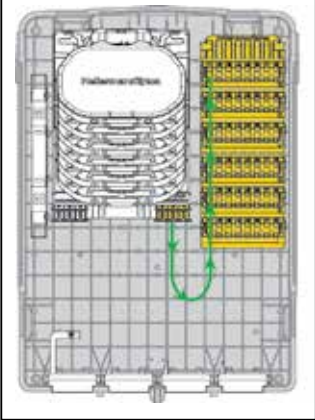

**BLM**

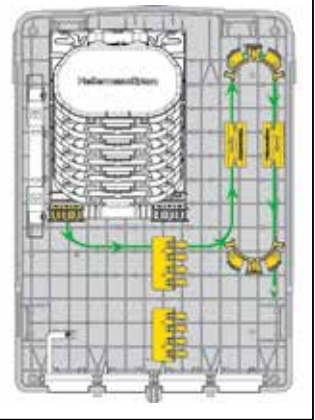

**LLWX / LLXN**

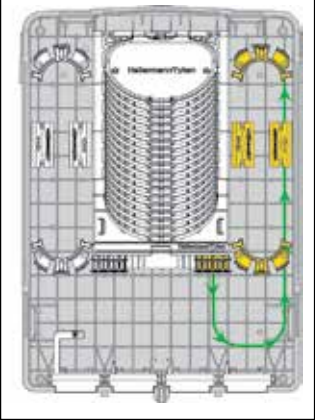

BXM

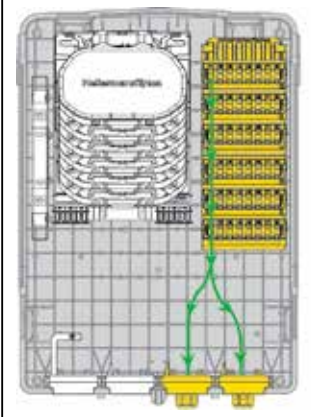

BLM



LLWX / LLXN

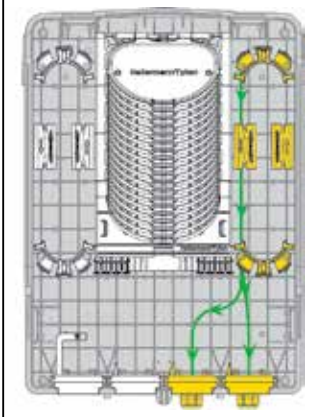



# HellermannTyton

Tel: +44 (0) 1604 706633  
www.htdata.co.uk

Stay in touch with us!

